

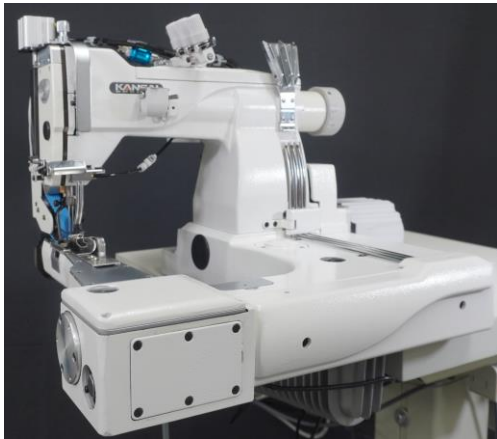

SQ7803LR-P/DD

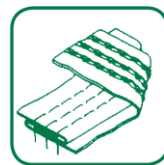

3 needle, double chain stitch, feed-off the arm machine, with a differential feeding system, Kansai Special original belt type rear puller and 850W direct drive motor.



Features

Kansai Special original Belt type rear puller device and needle cooler

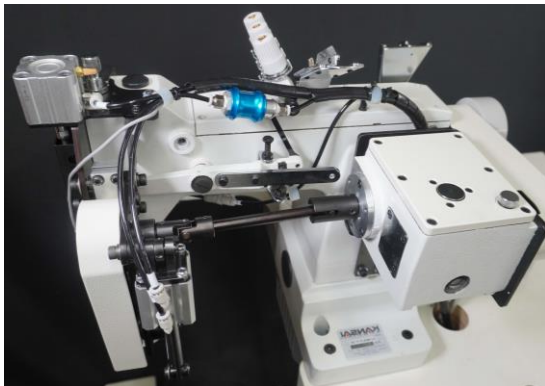

Push button stitch length adjustment



Differential feed mechanism
2 kinds of feed dogs are included in the machine

Left – Right diff. feed dog
Front – Back diff. feed dog

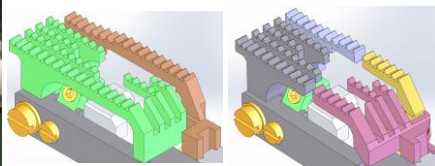

Chain cutter
✳Option

850W Direct motor



Model	Application	Material	Needle	No. of Threads	Gauge	Needle bar Stroke	Stitch length stitch/inch	Differential Feed ratio	Presser Foot lift	Maximum Speed
SQ7803LR-P/DD	Lap seam	Medium to heavy	TVx5 #22	6	1/4" 9/32"	35mm	2.1-4.2mm 6-12 stitch/inch	0.7-1.3	10mm	Machine 5000spm Motor 4000spm