

2 needle, double chainstitch, feed-off-the-arm, for tape attaching

# SQ7702FB-L-TC2/ST

2 needle, double chain stitch, feed-off-the-arm machine, with a differential feeding system for tape attaching with pneumatic foot lifter



## feature

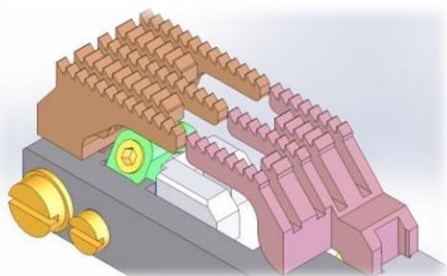

Differential feed mechanism ensures prevents puckering.



Equipped with a folder for tape attaching and a tape cutter that improves operator work.



New oil filtering system for clean oil and long durability.

The ST type table is compatible with belt motors, and can also be used with a chain-type foot lifter.



Model Name	Application	Material	Needle	No. of threads	Needle gauge	Needle bar stroke	Stitch length	Diff.Feed ratio	Presser foot lift	Maximum Speed
SQ7702FB-L-TC2/ST	Shorder tape	Knit wear	UYX128GAS #9-14	4	1/4"	31.3mm	1.4-3.2mm	0.7~1.3	8mm	5000

